

Map F. Zoning Districts-PARCELS- Town Property

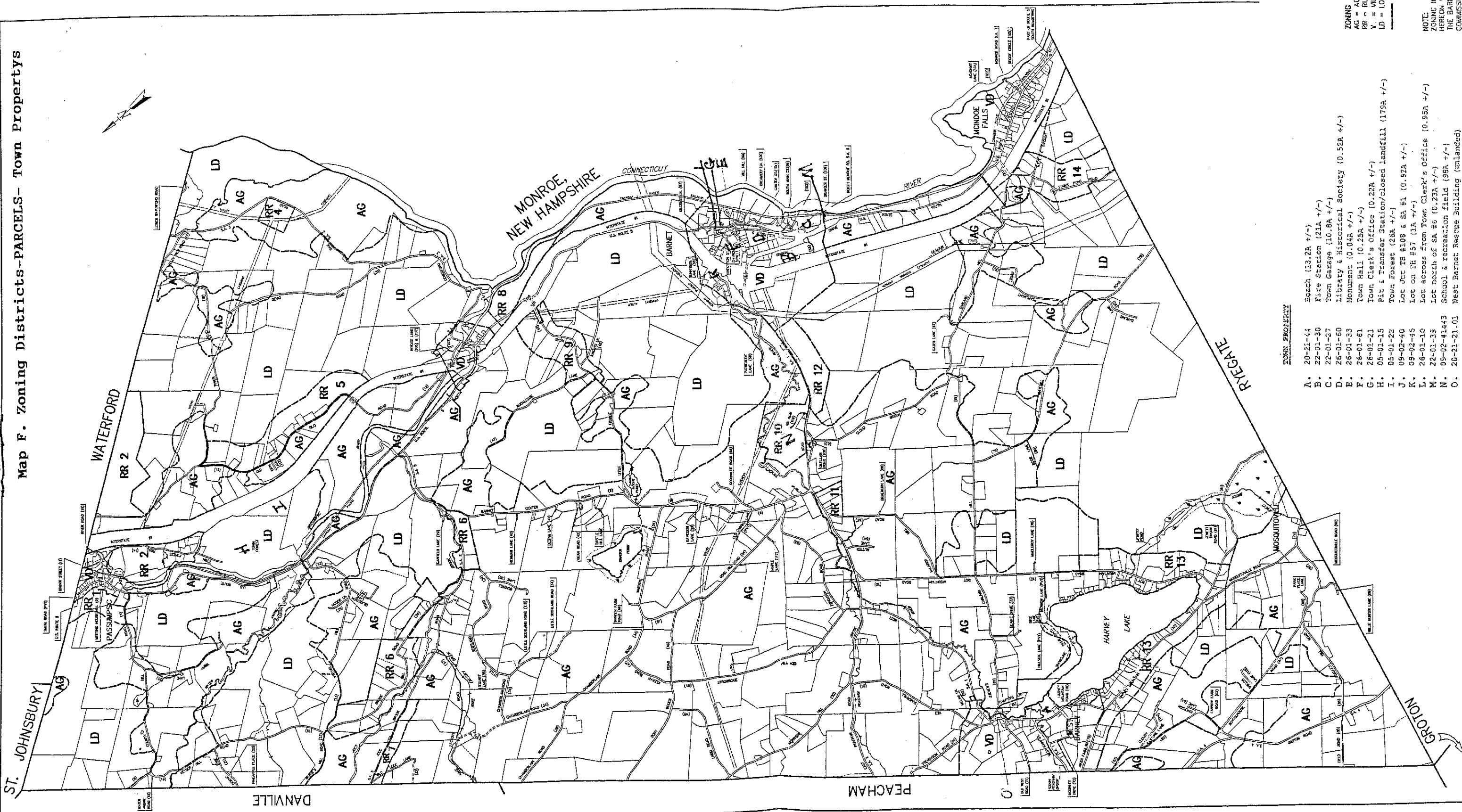

- TOWN PROPERTY**
- A. 20-21-44 Beach (13.2A +/-)
  - B. 22-01-30 Fire Station (21A +/-)
  - C. 22-01-27 Town Garage (10.8A +/-)
  - D. 26-01-60 Library & Historical Society (0.52A +/-)
  - E. 26-01-33 Monument (0.04A +/-)
  - F. 26-01-61 Town Hall (0.25A +/-)
  - G. 26-01-21 Town Clerk's Office (0.22A +/-)
  - H. 09-01-15 Pit & Transfer Station/Closed landfill (179A +/-)
  - I. 09-01-22 Town Forest (26A +/-)
  - J. 09-02-40 Lot Jct TH #108 & SA #1 (0.92A +/-)
  - K. 09-02-45 Lot on TH #57 (1A +/-)
  - L. 26-01-10 Lot across from Town Clerk's Office (0.99A +/-)
  - M. 22-01-35 Lot north of SA #6 (0.23A +/-)
  - N. 09-02-4143 School & recreation field (96A +/-)
  - O. 20-21-21-01 West Barnet Rescove Building (unlanded)

**ZONING LEGEND**  
 AG = AGRICULTURAL  
 PR = RURAL RESIDENTIAL  
 V = VILLAGE DISTRICT  
 LD = LOW DENSITY

**NOTE:**  
 INFORMATION SHOWN  
 HEREON WAS COMPILED BY  
 THE BARNET PLANNING  
 COMMISSION.

THIS MAP IS BASED ON THE TOWN OF BARNET PROPERTY MAPS. IT IS INTENDED FOR OFFICIAL USE AND PLANNING PURPOSES ONLY.

LEGEND

SCALE 1" = 1000'

APRIL 1, 2013

TOWN OF BARNET VERMONT

ZONING MAP